



Scotch Plains-Fanwood Public Schools Elementary Mathematics

Everyday Math Online Tech Support for Families

Students can access [EverydayMathOnline.com](https://www.everydaymath.com) [Here](#)
You should reach out to your classroom teacher for login information.

Errors and trouble accessing features of Everyday Math Online will vary depending on the device being used and the settings on each device. The following document has been developed to assist you with issues you may be having. If your child is unable to utilize Everyday Math Online or if you are not comfortable altering your device settings/downloading plug-ins on your device, please utilize the other resources listed in the [At-Home Learning Guides](#).

Contents

1. [System Requirements](#)
2. [User Guides](#)
3. [Pop-Ups, Flash, & Cookies](#)
4. [Downloading Plug-ins](#)

System Requirements



Minimum Technology Requirement for Everyday Mathematics®

System Requirements	
Macintosh	Windows
Operating System: Mac OS X 10.4 or above	Operating System: Windows XP, Vista, or Windows 7
Recommended	
Internet Connection : Broadband for school implementation	
Listening Device : Headphones (<i>preferred</i>)	
Applications : Microsoft Excel 2007	

Internet Browsers	
Macintosh	Windows
Firefox: v. 3.0 Safari: v. 3.0 or above	Internet Explorer: v. 7.0 or above Firefox: v. 3.0
Browser Plug-Ins	
Adobe Flash Player: v. 10.0 or later (<i>latest version is strongly recommended</i>)	
Adobe Shockwave: v. 10.1 or later (<i>latest version is strongly recommended</i>)	
Adobe Acrobat Reader: v. 8.0 or later (<i>latest version is strongly recommended</i>)	

Adobe System Inc's browser plugins are available as free downloads from www.adobe.com. You may test your installation at <http://adobe.com/shockwave/welcome/>.

User Guides

[Everyday Math Games User Guide](#)

[Parent Resources in English](#)

[Parent Resources in Spanish](#)

Pop-Ups, Flash, and Cookies

To maximize the functionality of everydaymathonline.com you should use **Google Chrome** as your browser.

After successfully logging in, you should see a lock to the left of the website address bar.



When you click on the lock you should see options for Flash, Pop-ups and redirects, and cookies. To make everydaymathonline.com as functional as possible you will want to "Allow" Flash and "Allow" Pop-ups and redirects.

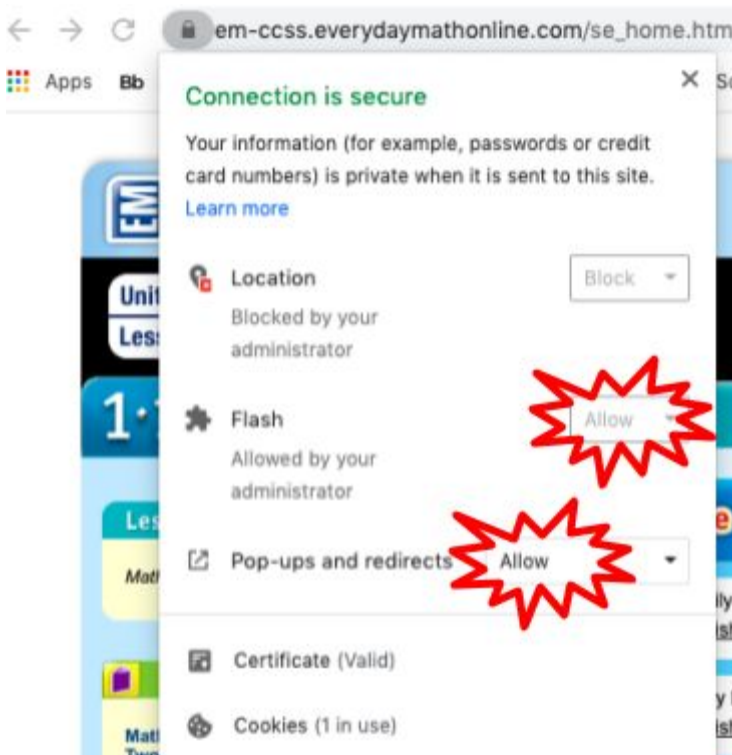

If prompted, you should also allow any cookies required to run the game.

Downloading Plug-Ins

To download Adobe Flash Player, click [Here](#)

For Adobe Flash Player support, click [Here](#)

To download Apple Quicktime, click [Here](#)